

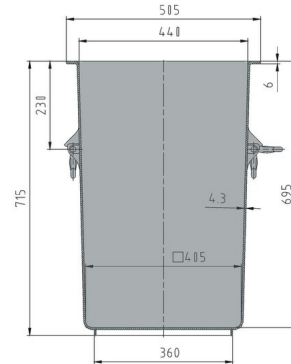





Large container

125l



Art. no. 81031010

Technical data			
External Dimensions (mm)	505 x 505 x 715		
Internal Dimensions (mm)	440 x 440 x 695		
Weight (kg)	5.8		
Volume (l)	125 l		
Material	PE		
Load capacity (kg)	 Holding Capacity 125 kg	 Extra Load 265	
Stacking height (mm)	 When nested 250	 When stacked 695	
Characteristics		Options	
Colour: white Nestable, stackable with lid For temperatures ranging from -30 °C to +40 °C, briefly up to +90 °C Resistant to most chemicals and cleaning agents Food-safe. HACCP compliant		Lid	
Loading quantities (Pcs / Approximate amount)			
On request			
Labelling			
Customised printing and numbering available on request depending on quantity. Position upon consultation.			



*1 All technical data include characteristic features, which have been tested under specially defined conditions. Varying data may result from different conditions of usage such as loading method, prevailing temperature and length of storage time. All data and specified information are subject to change without notice. Our service team is pleased to be at your disposal to check the special requirements of your individual application.