

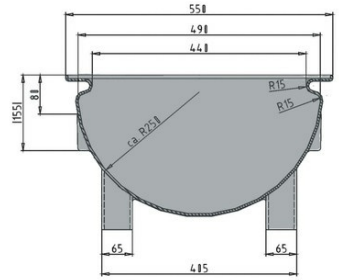

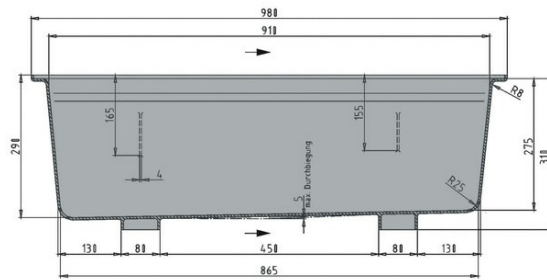

# Trough

100 l



Art. no. 81291010

### Technical data

External Dimensions L x W x H (mm)	980 x 550 x 310	
Internal Dimensions L x W x H (mm)	910 x 440 x 275	
Weight (kg)	6.3	
Volume (l)	100 l	
Material	PE	
Load capacity (kg)	 <b>Holding Capacity</b> 100 kg	 <b>Extra Load</b> -
Stacking height (mm)	 <b>When nested</b> 155	 <b>When stacked</b> -

### Characteristics

- Colour: white
- With feet
- Easy grip all around the top
- With drain and plug
- For temperatures ranging from -30 °C to +40 °C, briefly up to +90 °C
- Resistant to most chemicals and cleaning agents
- Food-safe. HACCP compliant

### Options

Stand

### Loading quantities (Pcs / Approximate amount)

On request

### Labelling

Customised printing and numbering available on request depending on quantity. Position upon consultation.



\*1 All technical data include characteristic features, which have been tested under specially defined conditions. Varying data may result from different conditions of usage such as loading method, prevailing temperature and length of storage time. All data and specified information are subject to change without notice. Our service team is pleased to be at your disposal to check the special requirements of your individual application.